

Sunday, April 4, 2010



Bathroom Demo Salvaged Material



Demo of rectory wall for new layout



Demo of rectory wall for new layout



Construction Update – April

Construction is schedule to being in full force on Monday, April 5. The Upper Church will no longer be used for weekly mass. The temporary church space in the Lower Level will be used beginning on April 10 thru July 2010. There will be three entrances to the Lower Level:

1. St. Cecilia Street Courtyard
2. St. Cecilia Street Main Door
3. Belvidere Street – Wheel Chair and Handicap Access

Over the month of April the Interior of the Upper Church will have scaffolding build to allow access to the ceiling of the Church for cleaning, lighting and fire protection. The pews will be removed to allow access for the new mechanical systems and refinish the floors. On the exterior scaffolding will be erected for the work at the masonry and roof. A portion of the front stairs will be behind a construction fence so the granite can be removed and cut so it can be reinstalled in the new stairs. Weekly photos will be provided in the back of the Lower Church for parishioners to see the progress.

Saint Cecilia
PARISH

ST. CECILIA'S PARISH RENOVATION
Access to Temporary Church Space

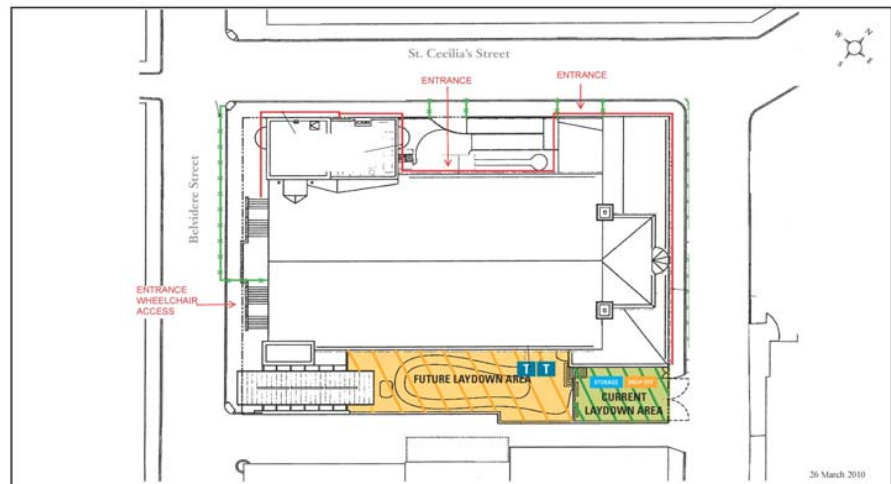

Questions or Concerns

Your questions and concerns are important to us. Please contact the Parish Office and they will direct your inquiry to Prudence Parry, Project Manager and Bert Clarke, Project Superintendent. Thanks!